

A
SCALE: 1 : 5

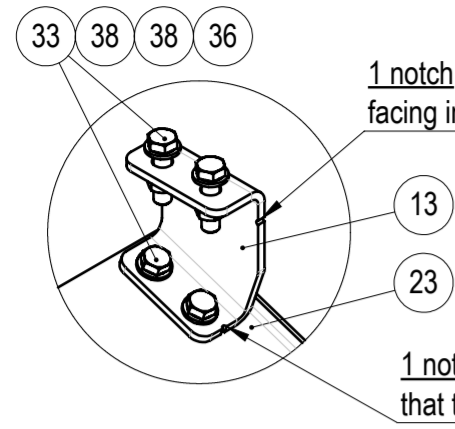

1 notch positioned on the upper part of the bracket's side, facing inward toward the tunnel centerline.

1 notch on the bracket foot indicates that the bracket is "Left"

B
SCALE: 1 : 5

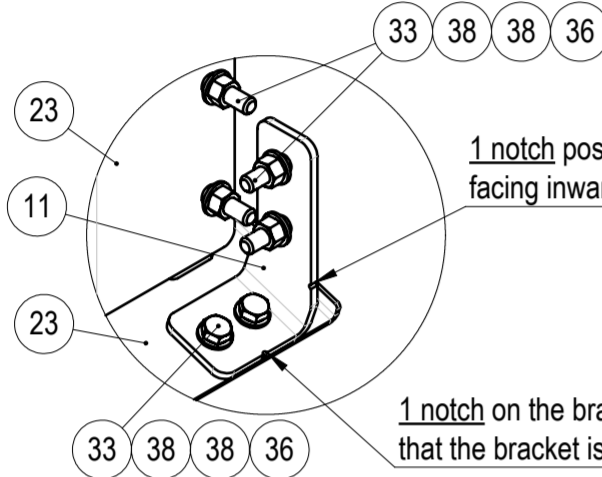

1 notch positioned on the lower part of the bracket's side, facing inward toward the tunnel centerline.

1 notch on the bracket foot indicates that the bracket is "Left"

C
SCALE: 1 : 5

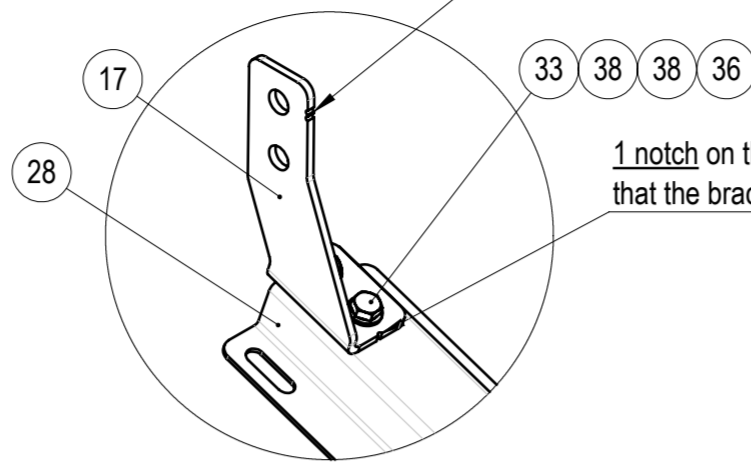

2 notches positioned on the upper part of the bracket's side, facing inward toward the tunnel centerline.

1 notch on the bracket foot indicates that the bracket is "Left"

D
SCALE: 1 : 5

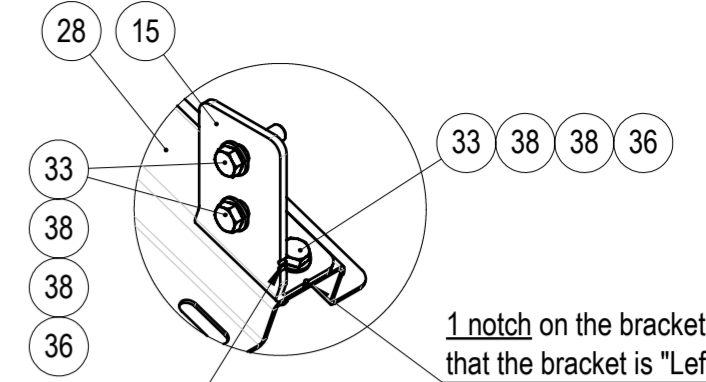

2 notches positioned on the lower part of the bracket's side, facing inward toward the tunnel centerline.

1 notch on the bracket foot indicates that the bracket is "Left"

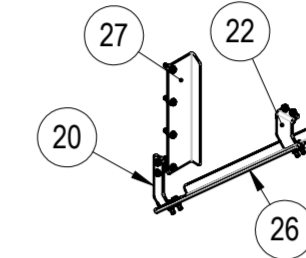
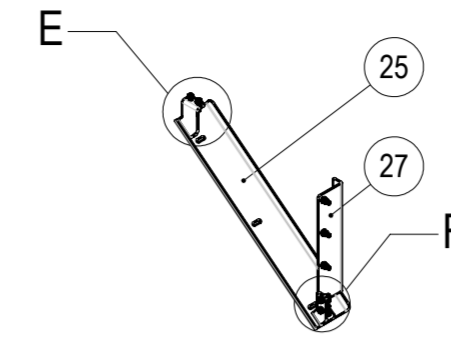

F
SCALE: 1 : 5

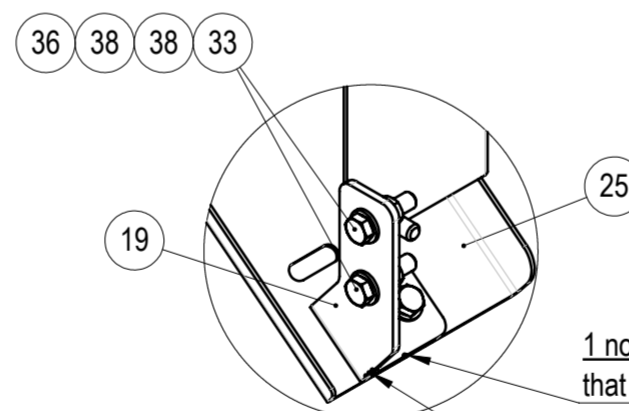

1 notch on the bracket foot indicates that the bracket is "Left"

3 notches positioned on the lower part of the bracket's side, facing inward toward the tunnel centerline.

E
SCALE: 1 : 5

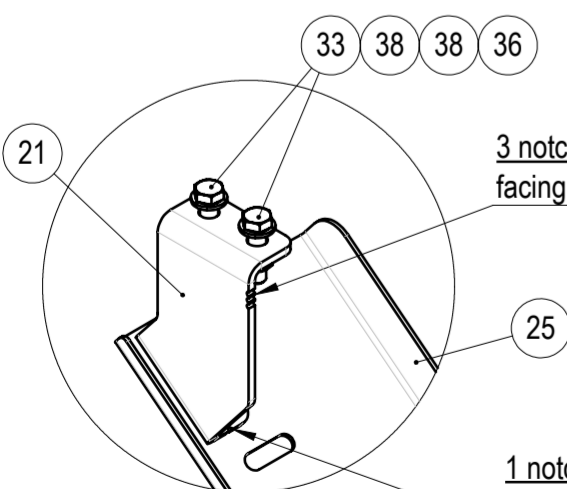

3 notches positioned on the upper part of the bracket's side, facing inward toward the tunnel centerline.

1 notch on the bracket foot indicates that the bracket is "Left"

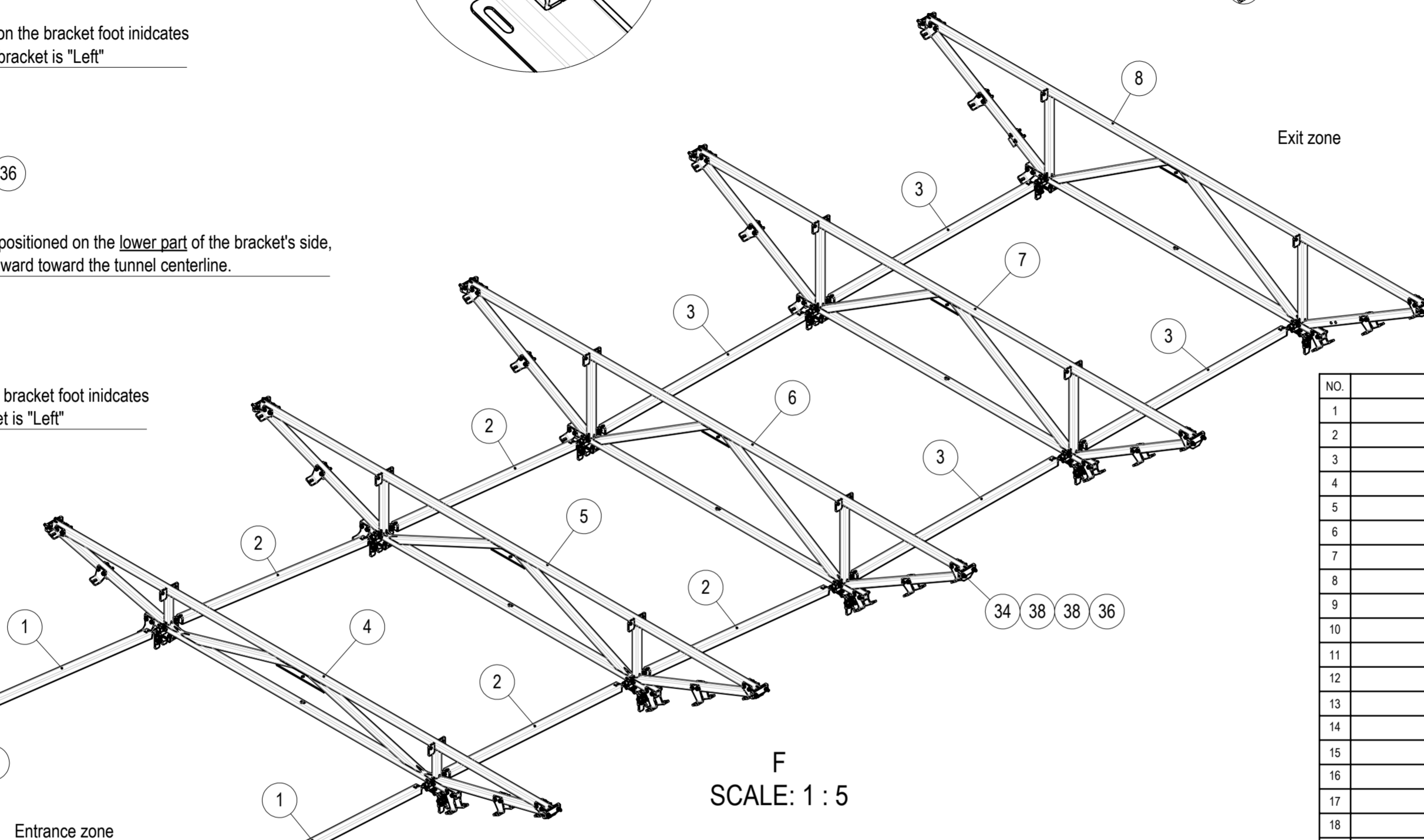

Bracket Positioning Note:

- Brackets 11; 12; 13; 14; 15; 16; 17; 18; 19; 20; 21 & 22 have notches for correct positioning.
- Brackets located farther from the tunnel centerline have notches positioned on the upper part of the bracket's side.
- Brackets located closer to the tunnel centerline have notches positioned on the lower part of the bracket's side.
- Left brackets have 1 identification notch on the bracket foot.
- Right brackets have 2 identification notch on the bracket foot.
- Refer to detail views A; B; C; D; E & F for notch positioning of left-side brackets.

Fastening Note:

- For all fasteners, apply Loctite 243 during final assembly.

NO.	PART NO	DESCRIPTION	MATERIAL	PROCESSING	REVISION	WEIGHT	QTY
1	105-09201-00	Tie link 1	-	ASY		11.23	2
2	105-09203-00	Tie link 2	-	ASY		11.04	4
3	105-09205-00	Tie link 3	-	ASY		12.13	4
4	105-09211-00	Hanging frame assembly 1	-	ASY		102.95	1
5	105-09212-00	Hanging frame assembly 2	-	ASY		107.36	1
6	105-09213-00	Hanging frame assembly 3	-	ASY		112.43	1
7	105-09214-00	Hanging frame assembly 4	-	ASY		113.00	1
8	105-09215-00	Hanging frame assembly 5	-	ASY		110.71	1
9	105-09100-01	Glass holding plate	AISI 304	LC		0.51	2
10	105-09100-02	Plastic shimplate 1mm	POM / black	MCH		0.01	6
11	105-09100-63	Left bracket C1-L	S355J2	LCB HDG		0.54	1
12	105-09100-64	Right bracket C1-L	S355J2	LCB HDG		0.54	1
13	105-09100-65	Left bracket C1-U	S355J2	LCB HDG		0.68	1
14	105-09100-66	Right bracket C1-U	S355J2	LCB HDG		0.68	1
15	105-09100-67	Left bracket HL	S355J2	LCB HDG		0.59	1
16	105-09100-68	Right bracket HL	S355J2	LCB HDG		0.59	1
17	105-09100-69	Left bracket HU	S355J2	LCB HDG		0.69	1
18	105-09100-70	Right bracket HU	S355J2	LCB HDG		0.69	1
19	105-09100-71	Left bracket C2-L	S355J2	LCB HDG		0.56	1
20	105-09100-72	Right bracket C2-L	S355J2	LCB HDG		0.78	1
21	105-09100-73	Left bracket C2-U	S355J2	LCB HDG		0.85	1
22	105-09100-74	Right bracket C2-U	S355J2	LCB HDG		0.88	1
23	105-09200-01	Left corner plate 1	DX51D+Z275	LCB PNT		5.54	1
24	105-09200-02	Right corner plate 1	DX51D+Z275	LCB PNT		5.54	1
25	105-09200-03	Left corner plate 2	DX51D+Z275	LCB PNT		5.21	1
26	105-09200-04	Right corner plate 2	DX51D+Z275	LCB PNT		5.52	1
27	105-09200-05	Exit side corner plate	DX51D+Z275	LCB PNT		2.19	2
28	105-09200-06	Hat bracket	S355	LCB HDG		3.53	2
29	105-09200-07	Shimplate 2mm	DX51D+Z275	LC		0.11	30
30	105-09200-08	Plastic shimplate 5mm	POM / black	MCH		0.03	2
31	105-09200-09	Plastic shimplate 2mm	POM / black	MCH		0.01	4
32	Loctite 243	Threadlocking adhesive medium strength 10ml	-	COTS		0.00	1
33	ISO4017 (DIN933) M12x45	Hex bolt	HDG-8.8	COTS		0.06	56
34	ISO4017 (DIN933) M12x50	Hex bolt	HDG-8.8	COTS		0.06	20
35	ISO4017 (DIN933) M12x50	Hex bolt	A2-70	COTS		0.06	4
36	ISO4032 (DIN934) M12	Hex nut	HDG-8	COTS		0.02	76
37	ISO4032 (DIN934) M12	Hex nut	A2-70	COTS		0.02	4
38	ISO7089 (DIN125) M12	Plain Washer	HDG-HV200	COTS		0.01	152
39	ISO7093 (DIN9021) M12	Large plain washer	A2-HV200	COTS		0.02	8
40	ISO7093 (DIN9021) M12	Large plain washer	Nylon	COTS		0.00	4

WEMPS
ENGINEERING SERVICES

MATERIAL	WEIGHT	DEBURR AND BREAK SHARP EDGES	REVISION	DATE
-	714.419 Kg	DO NOT SCALE DRAWING		11.05.2026
SURFACE PROTECTION	MACHINING	THERMAL CUTTING	WELDING	SCALE
-	ISO 2768 mK	ISO 9013 221	ISO 13920 BF	1:30
NAME	SIGNATURE	PART NO.	FORMAT	
Designed by D. Dislers		105-09200-00	A2	
Drawn by D. Dislers		DESCRIPTION	SHEET 1/2	
Technical ref		Hanging frame installation assembly		

Top View (Reference Components Shown for Assembly Context)

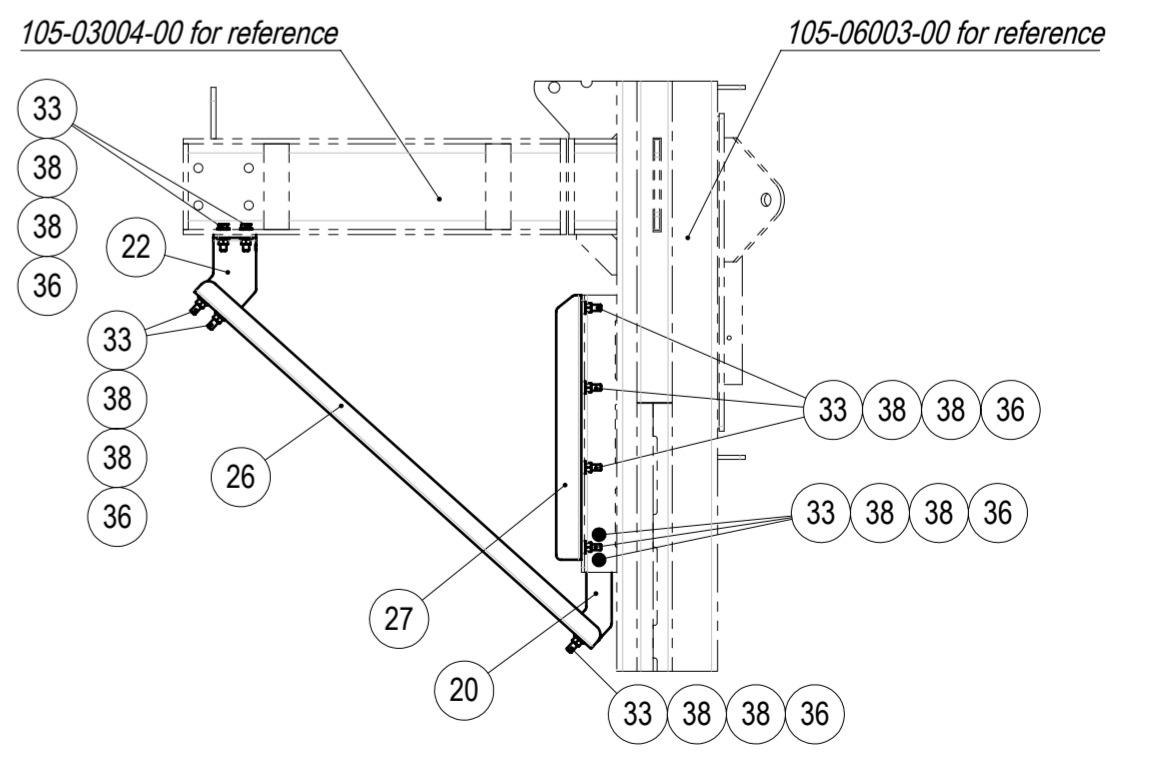
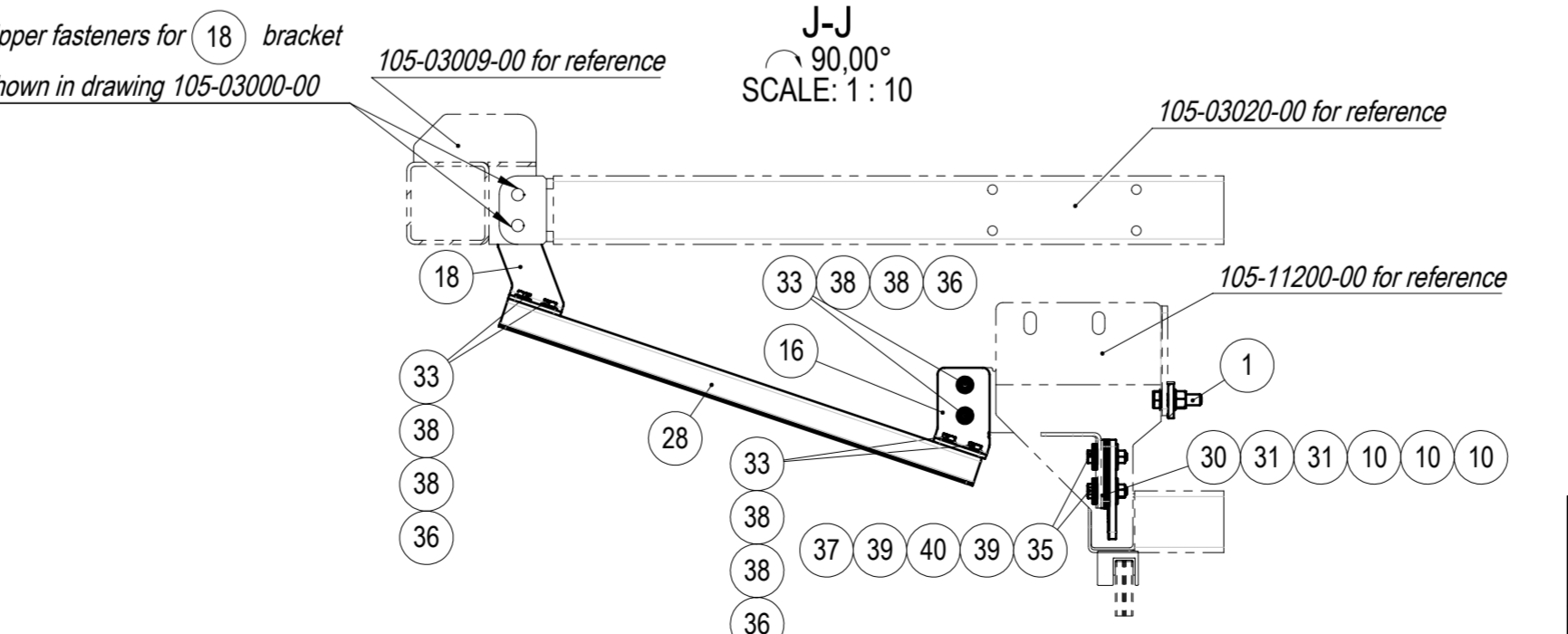
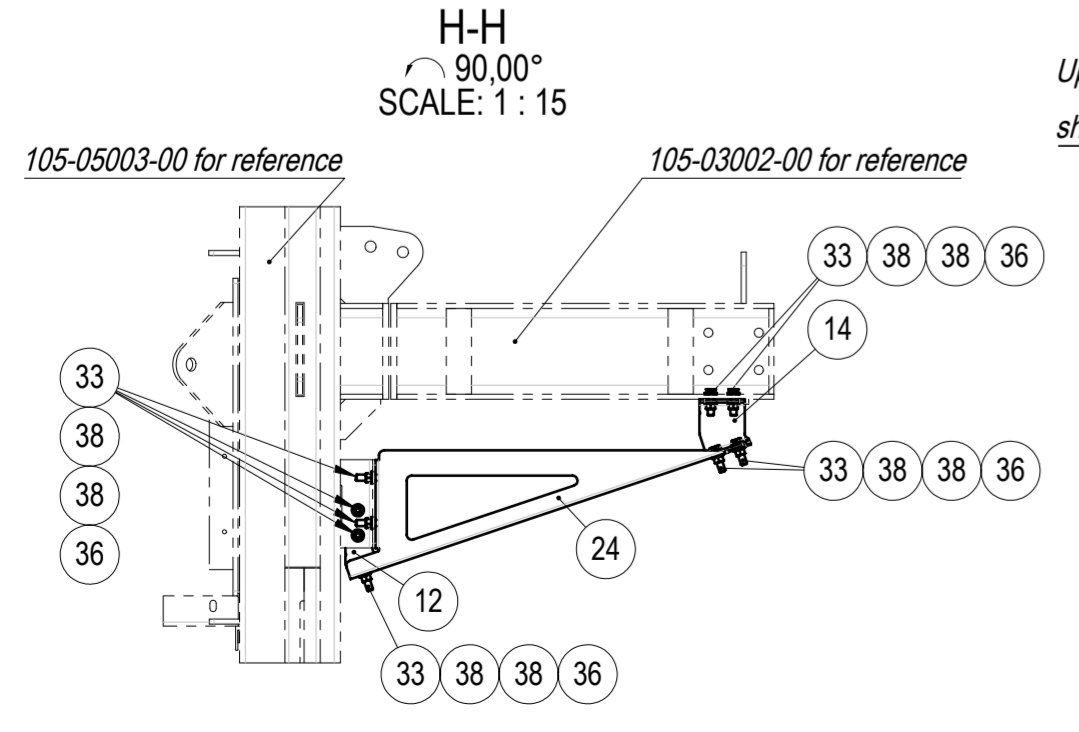
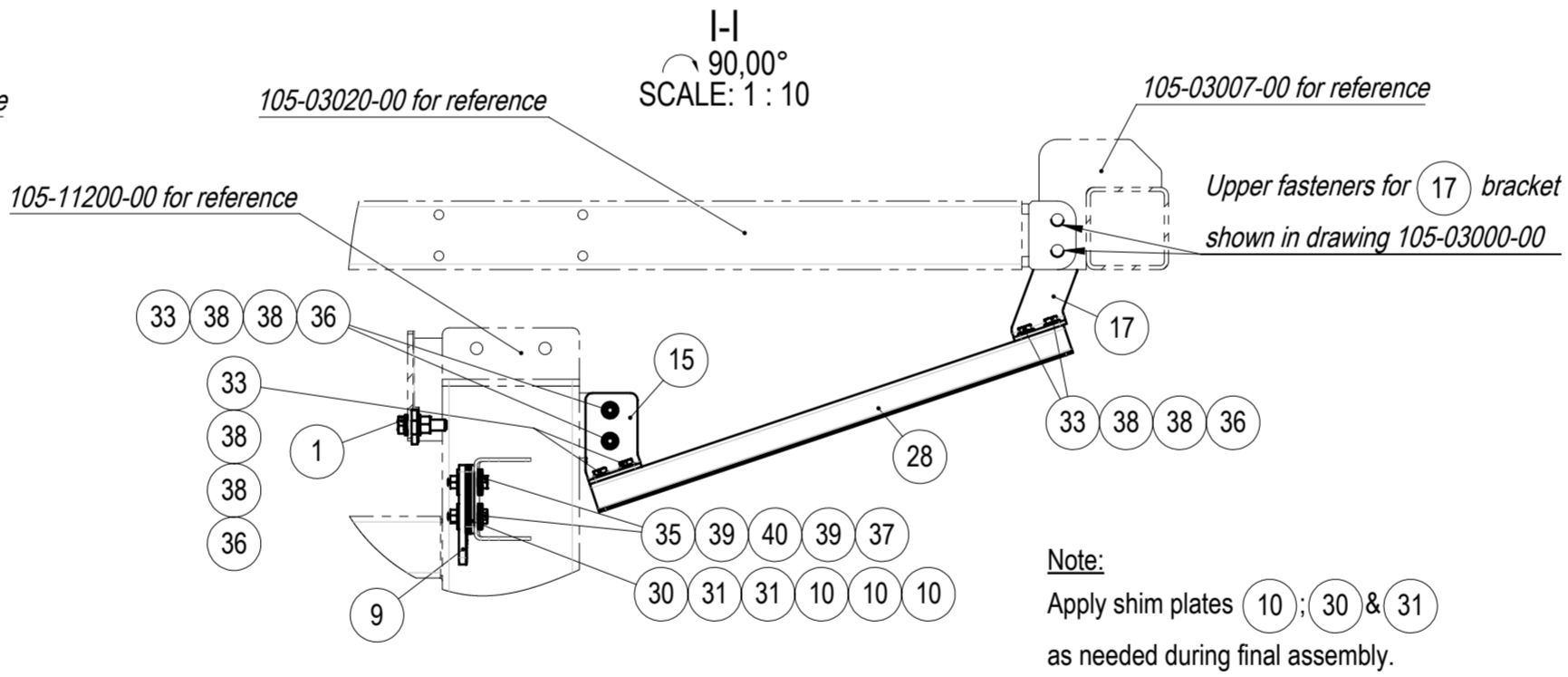
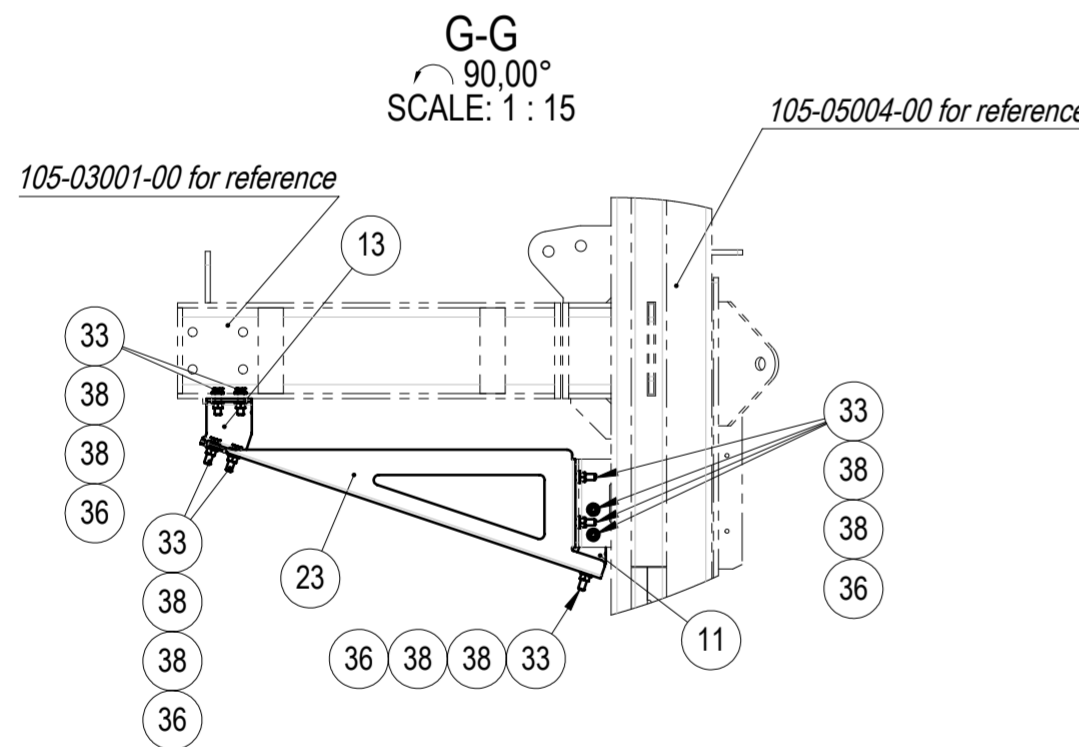
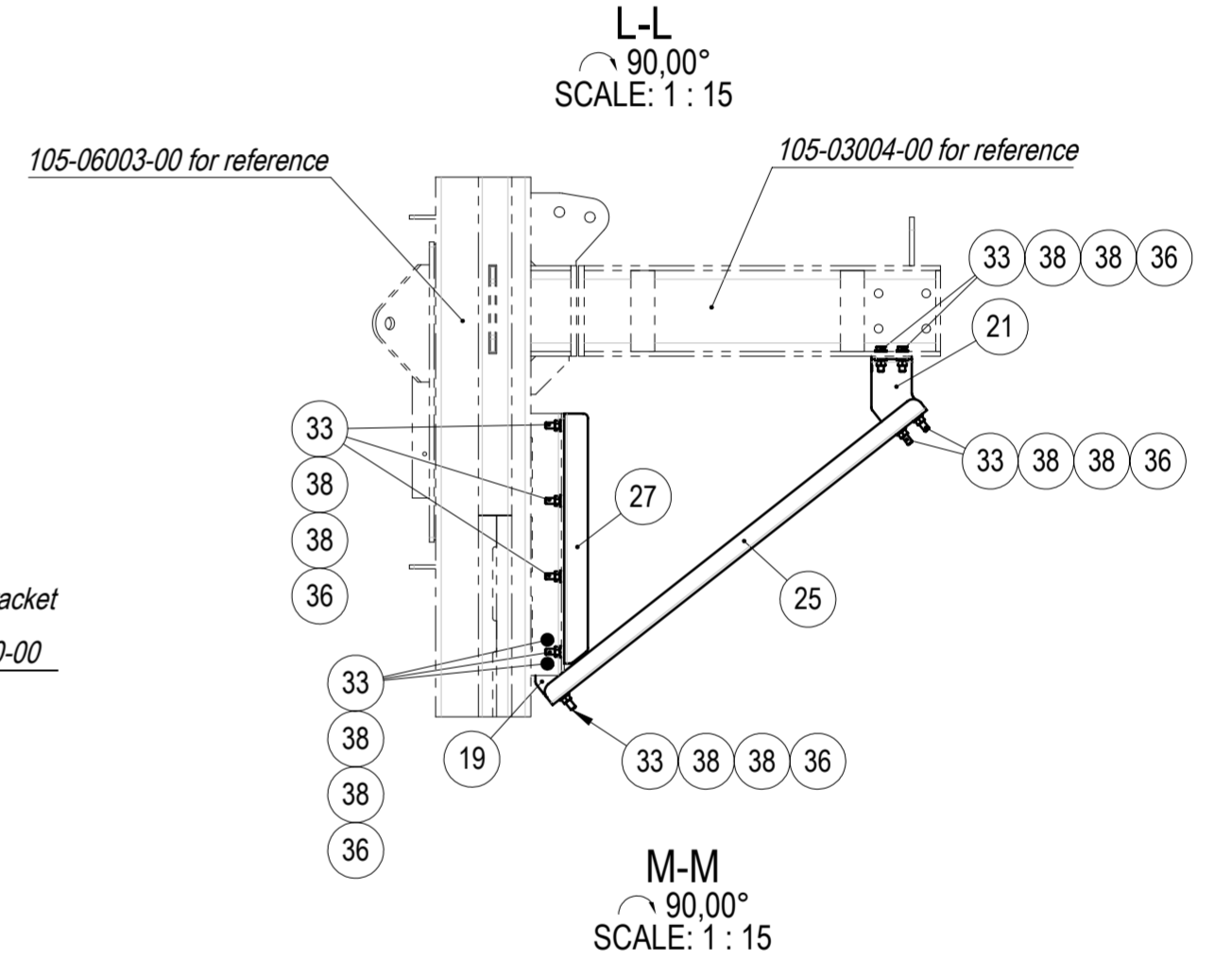
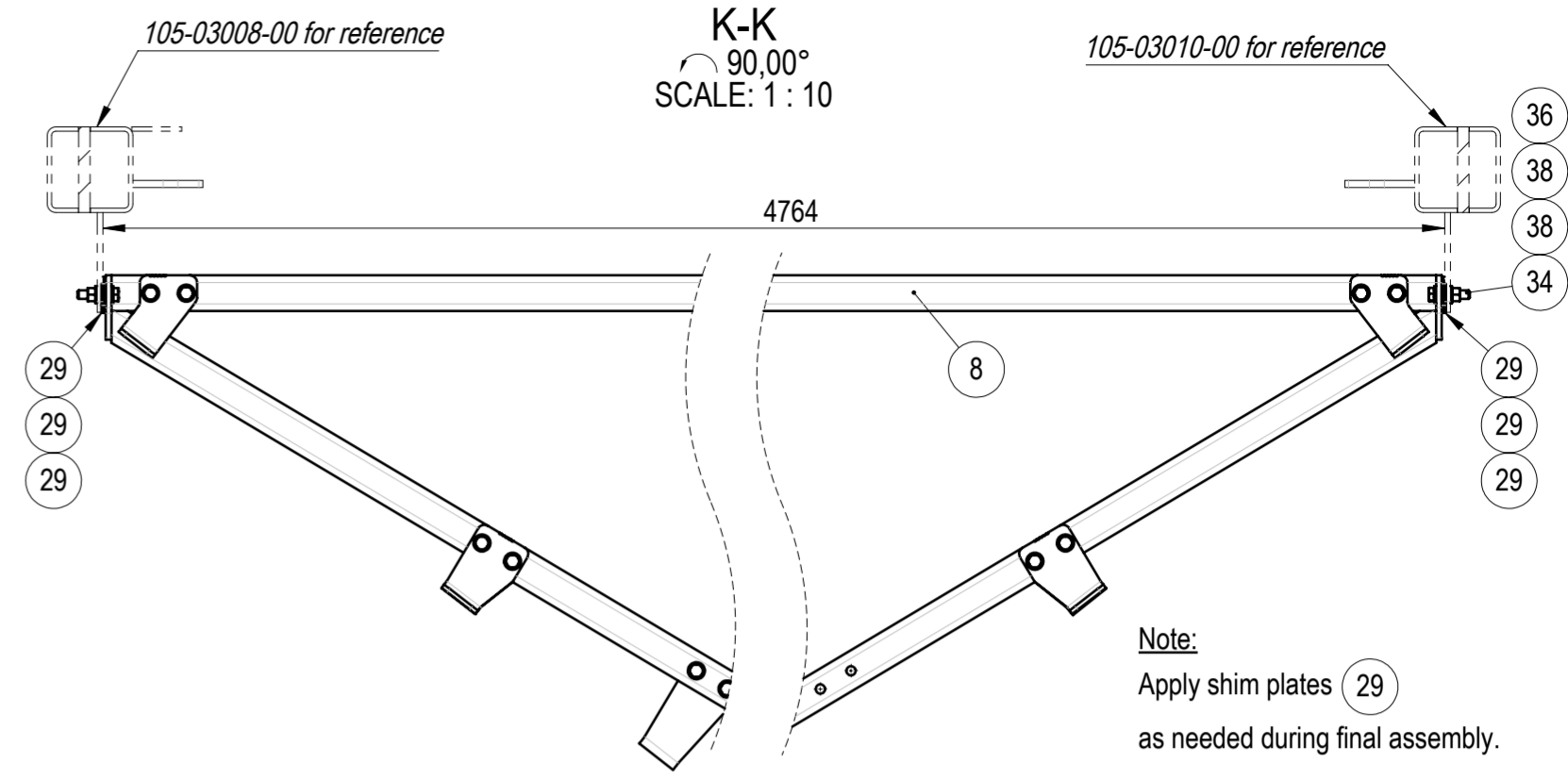
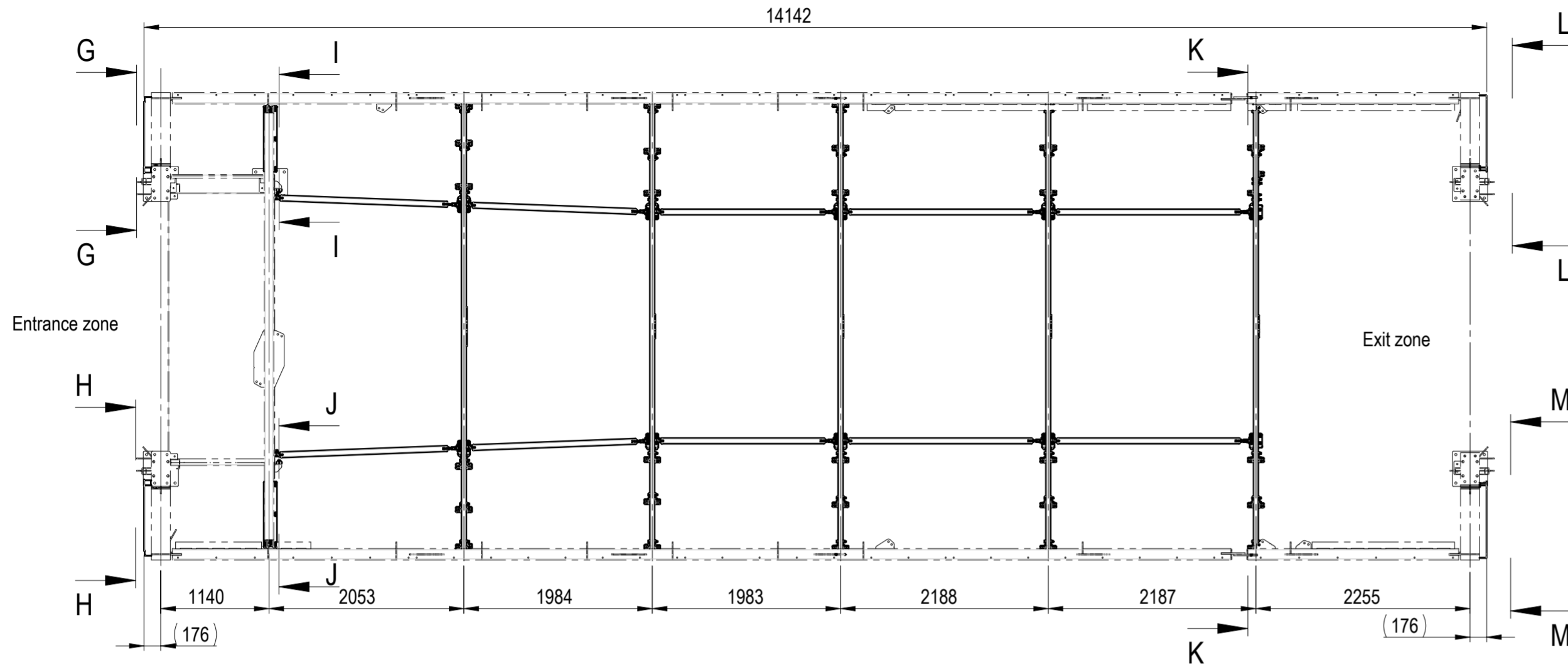

WEMPS ENGINEERING SERVICES	MATERIAL	WEIGHT	DEBURR AND BREAK SHARP EDGES	REVISION	DATE
	-	714.419 Kg	DO NOT SCALE DRAWING		11.05.2026
	SURFACE PROTECTION	MACHINING	THERMAL CUTTING	WELDING	SCALE
	-	ISO 2768 mK	ISO 9013 221	ISO 13920 BF	1:50
	NAME	SIGNATURE	PART NO.	105-09200-00	
Designed by	D. Dislers				
Drawn by	D. Dislers				
Technical ref.			DESCRIPTION	Hanging frame installation assembly	
					SHEET 2/2